

- LEGENDE
-  Tischgruppen:52
total seats:52
 -  Einzeltische:3
total seats:3

Gesamtplätze:107
total seats:107

max. Bauhöhe:4.00m
max. useable clear height: 4.00m

max. Bauhöhe niedriger Bereich
(unter Balkone und Lautsprecher): 2.50m





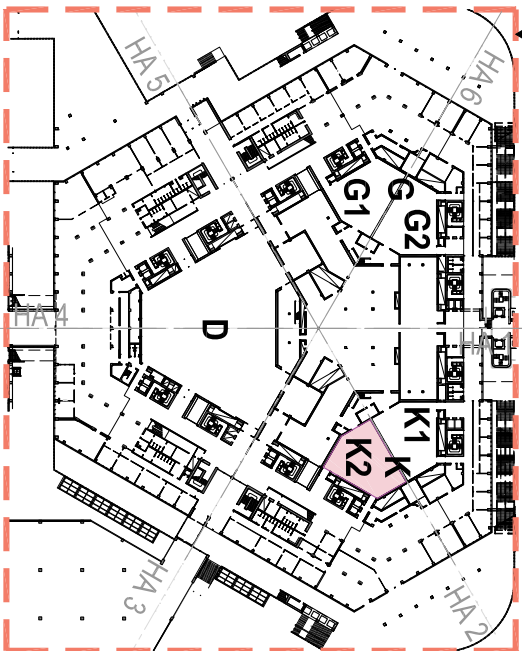

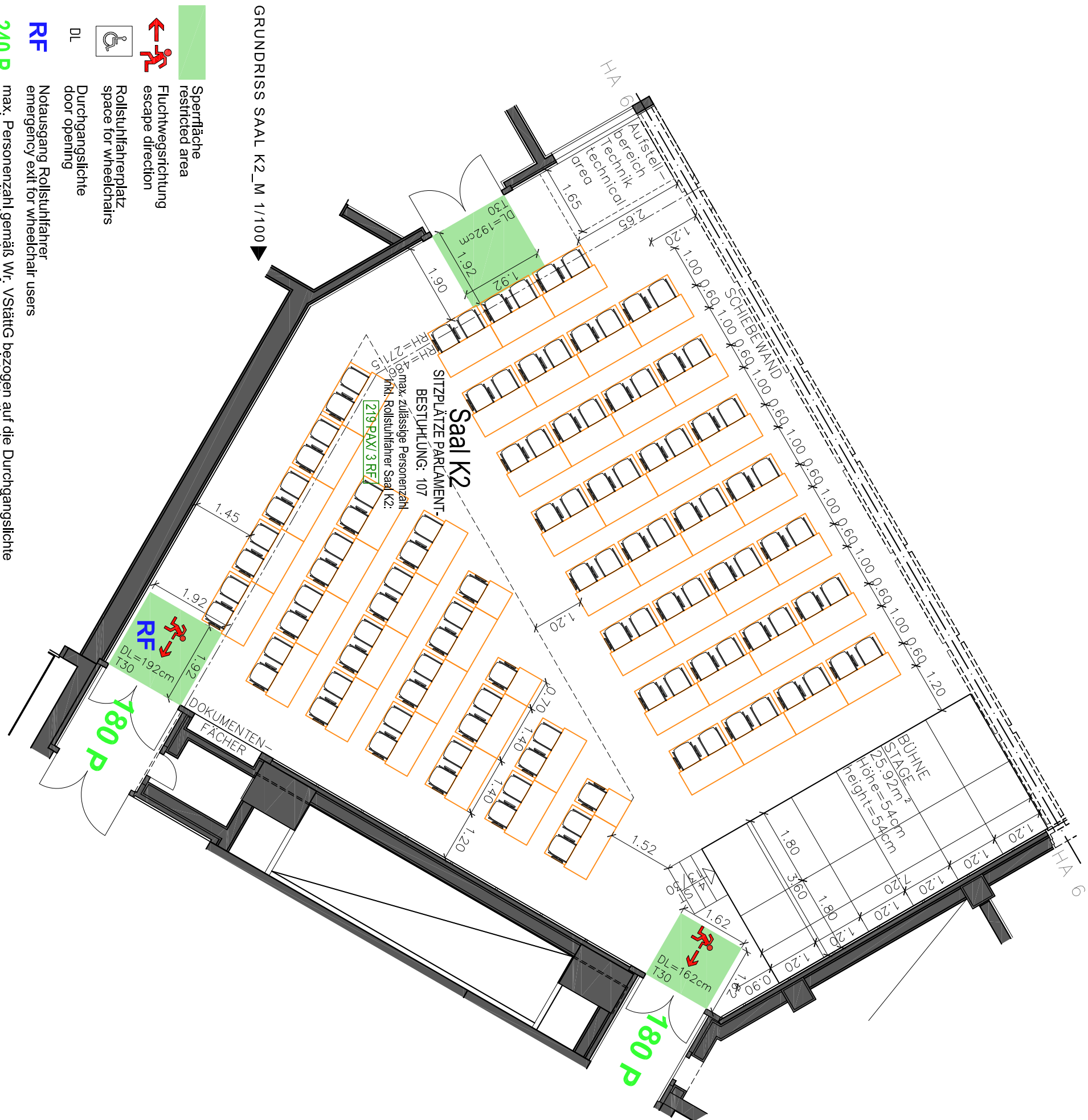

max. useable clear hight low area
(below balcony and technical booths): 2.50m

VERORTUNG SAAL K2
M 1/2000



GRUNDRISS SAAL K2_M 1/100



-  Sperrfläche
restricted area
-  Fluchtwegsrichtung
escape direction
-  Rollstuhlfahrerplatz
space for wheelchairs
-  Durchgangsslichte
door opening
-  DL
-  Notausgang Rollstuhlfahrer
emergency exit for wheelchair users
-  240 P
max. Personenzahl gemäß Nr. VStättG bezogen auf die Durchgangsslichte
maximum permitted number of persons related to the door opening
-  219 PAX
max. zulässige Personenzahl inkl. Rollstuhlfahrer
maximum permitted number of persons inclusive
wheelchair users

0 2 4 6 8 10 12 14 16 18 20 22 24 26 28 30 32 34 36 [m]

DIE GESAMTBEBLEUNG DER EINZELNEN RÄUME DARF DIE GESAMTPERSONENANZAHL PRO EBENE NICHT ÜBERSCHREITEN!